

**THIS IS A PERMIT APPLICATION  
ONLY AND DOES NOT GIVE  
PERMISSION TO BEGIN WORK**

# CITY OF PACIFICA

## ENGINEERING PERMIT APPLICATION

**APPLICANT TO COMPLETE ALL FIELDS (and sign below)**

LOCATION OF WORK: \_\_\_\_\_  
DESCRIPTION OF WORK: \_\_\_\_\_

PROPERTY OWNER(S): \_\_\_\_\_  
PERMITTEE: Name: \_\_\_\_\_

*If other than property owner, statement of authorization to act as agent of property owner must be attached.*

Address: \_\_\_\_\_ License # and Class: \_\_\_\_\_  
Phone and Email: \_\_\_\_\_ Expiration date: \_\_\_\_\_  
Contractor: \_\_\_\_\_  
Pacifica Business License # and Expiration date: \_\_\_\_\_

**Contractor needs to provide a Certificate of Insurance and Endorsement page, naming the City as an additional insured.**

Is the work to be performed within the dripline of a Heritage Tree as defined under Pacifica Municipal Code Chapter 12?

YES  NO

PLANS FOR THIS PERMIT ARE ATTACHED AND TITLED: \_\_\_\_\_

By: \_\_\_\_\_ Dated: \_\_\_\_\_

Permittee hereby agrees to the following conditions of said encroachment permit:

1. Permittee shall perform all work in accordance with the standard specifications of the City of Pacifica and/or in accordance with the requirements of the City Engineer.
2. Permittee shall allow the City Engineer and/or his authorized representatives access to inspect all work performed under this permit.
3. Permittee shall pay all expenses incurred by the City in inspecting the work and enforcing the requirements herein.
4. The City Engineer may require either a Faithful Performance Bond and/or Maintenance Bond, or a cash deposit, in an amount not to exceed the estimated cost of the proposed work hereunder, which shall be paid in advance.
5. Permittee shall notify the City Engineer and/or his representative at 650 738-3767 **at least 24 hours prior to performing any work. All Engineering inspections require 24-hour advance notice.**
6. All work shall be complete on or before \_\_\_\_\_. Encroachment permit may be revoked at any time if deemed necessary by the City Engineer.
7. Comply with all applicable requirements of the Pacifica Municipal Code, Administrative Policies and State and Federal laws.
8. **This permit is not a substitute for a heritage tree permit. It does not allow the substantial trimming, cutting of roots or any activity that would harm or damage any heritage tree as defined under Pacifica Municipal Code Chapter 12.**
9. Contractor shall notify and coordinate work with all utilities, Recology and Sam Trans.

The permittee and/or property owner by acceptance of this permit, agrees to indemnify, defend and hold harmless the City of Pacifica from and against any and all claims, demands and legal actions for injuries or damages to persons or property resulting from operations or maintenance under this permit, regardless of passive negligence of the City of Pacifica, its officers, employees, consultants and agents, and agrees to compensate the City in full for all damages to property of the City or to public property under its jurisdiction resulting from operations or maintenance under this permit.

This encroachment permit is revocable and may be revoked or modified by the City at any time upon ten days' written notice to the permittee. Upon revocation of the permit, the permittee shall, at no expense to the City, remove all improvements, obstructions and plantings placed within the permit area and restore the permit area to the conditions that existed prior to the issuance of this permit to the satisfaction of the City Engineer.

### PERMITTEE

By \_\_\_\_\_  
**Authorized agent**

Fees (to be assessed by City Engineer):

Application fee \$ \_\_\_\_\_  
Engineering inspection fee \$ \_\_\_\_\_  
Bond \$ \_\_\_\_\_

**THIS IS A PERMIT  
APPLICATION ONLY  
AND DOES NOT GIVE  
PERMISSION TO BEGIN  
WORK**

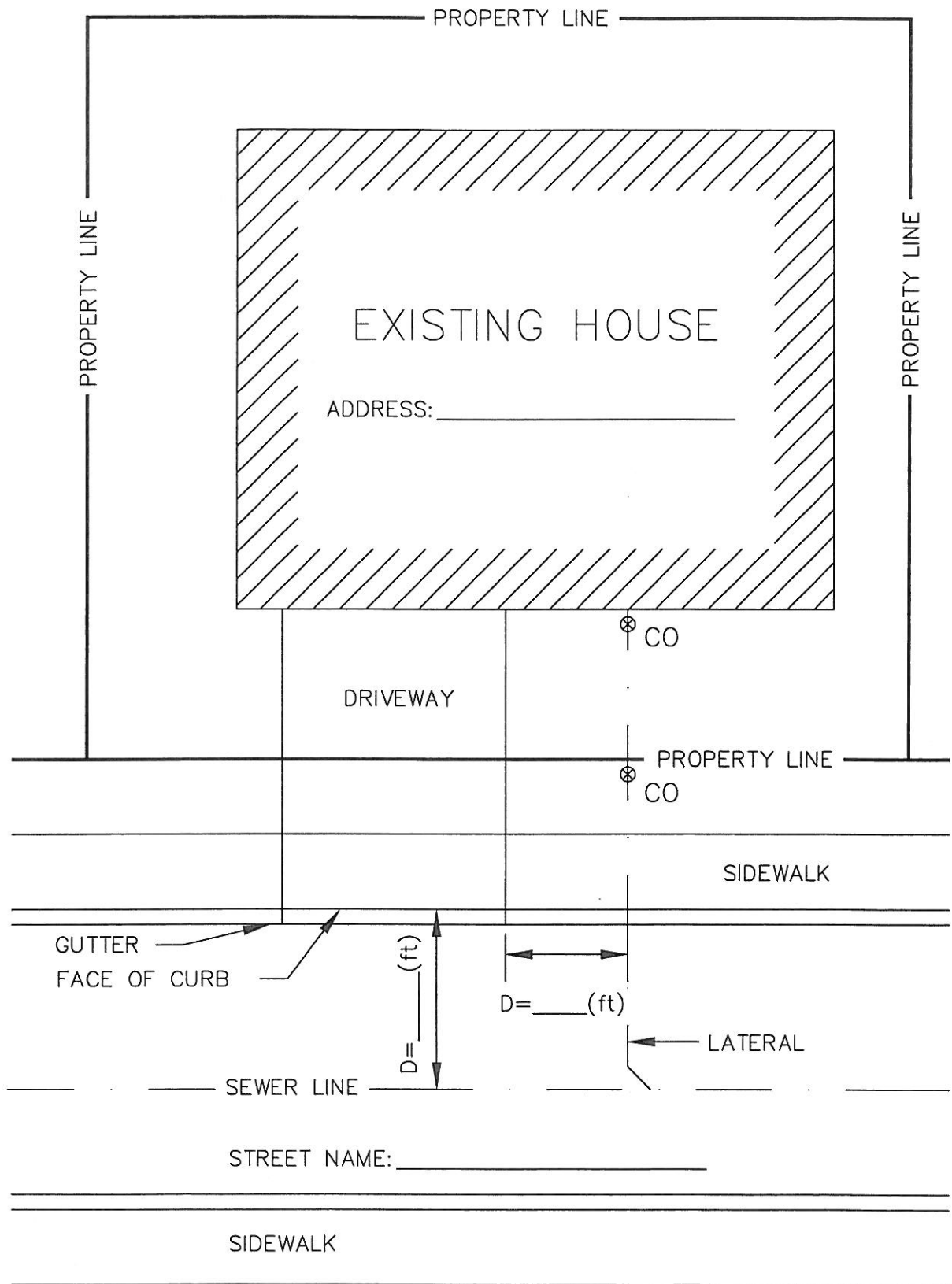

NOTE:  
 1. INDICATE LOCATION OF DRIVEWAY  
 2. PROVIDE ALL NECESSARY DIMENSIONS

**CITY OF PACIFICA**  
 PUBLIC WORKS / ENGINEERING DIVISION

DESIGNED BY: \_\_\_\_\_ DATE: \_\_\_\_\_  
 DRAWN BY: \_\_\_\_\_  
 CHK'D BY: \_\_\_\_\_  
 APPROVED BY: \_\_\_\_\_

**ENCROACHMENT PERMIT WORK FOR:**

ADDRESS: \_\_\_\_\_  
 NATURE OF WORK: \_\_\_\_\_

**GENERAL SITE PLAN**

SCALE: NO SCALE  
 PLAN NO. \_\_\_\_\_